

MODEL	SPECIFICATIONS
96/1	(3 – 5,5V)
ANTENNA TYPE	Mobile active GPS antenna for roof or bracket mounting (bolt-on type) <ul style="list-style-type: none">• NON-CORROSIVE• LOW PROFILE DESIGN• WATER PROOF
FREQUENCY	1575,42 MHz
IMPEDANCE	Nom. 50 Ω
POLARISATION	RHC (Right Hand Circular)
GAIN (LNA) NOISE FIG.	Nom. 26 dB Typ. 1.35 dB
POWER SUPPLY	+ 3,0 - 5,5 VDC / 20 mA
VSWR	< 2.0
DIMENSIONS	Ø 47 x 15 mm
COLOUR	Black
MOUNTING-HOLE BUILD-IN DEPTH	Ø 13 mm Approx. 17 mm
WEIGHT	Approx. 60 g
MOUNTING	On horizontal surface or on bracket with free sight to satellites
MATERIAL	ABS, stainless steel and brass IP65 Classified (when mounted on vehicle)

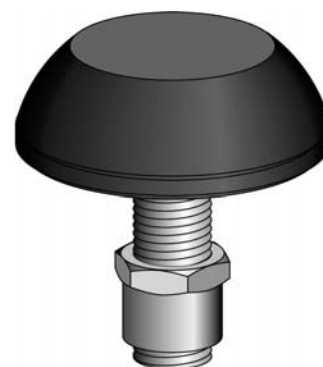

MOUNT TYPE	Bolt-on
CABLE / CONNECTOR	No extension cable supplied / FME (m) in base